

ROLAIR

SCHEMATIC FOR PMP22K24

PRODUCTION PRIOR TO 8/02

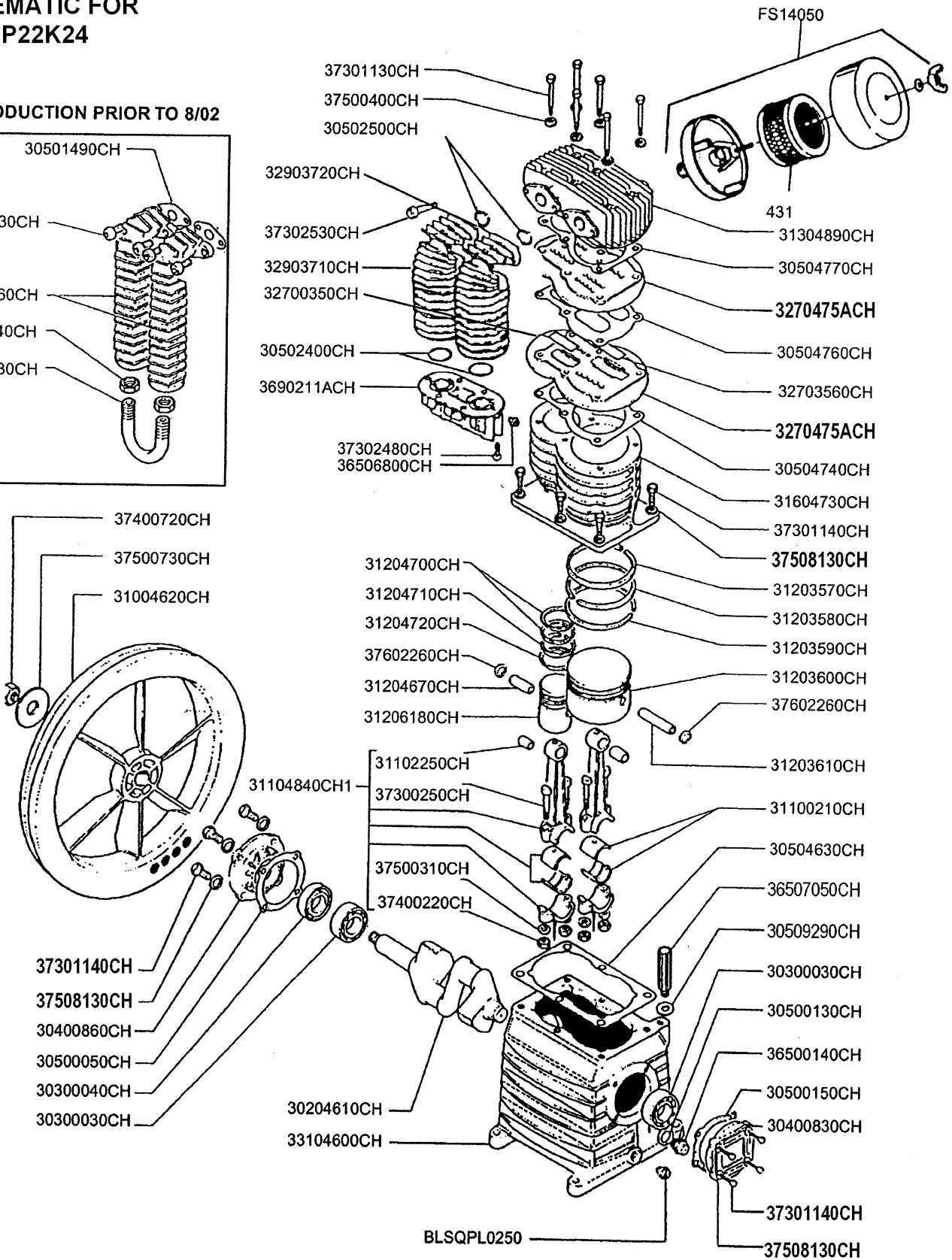

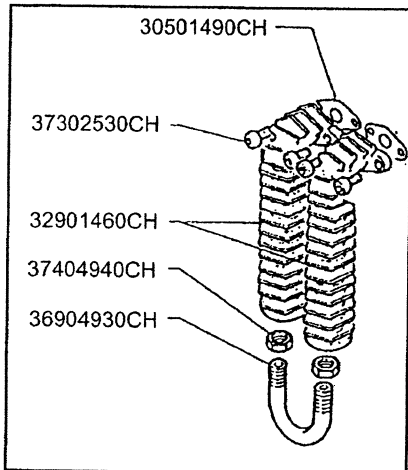
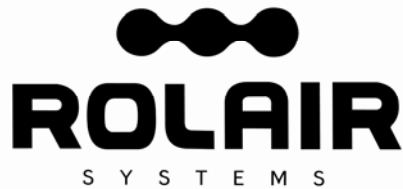

ROLAIR SYSTEMS

606 S. Lake Street, P.O. Box 346
Hustisford Wisconsin 53034-0346
Phone: 920-349-3281
Sales Fax: 920.349.3691
Service Fax: 920.349.8861
www.rolair.com

PARTS LIST FOR PMP22K24

Description	Part #	Qty.	Description	Part #	Qty.
Crankshaft	30204610CH	1	Left Intercooler	32903710CH	1
Bearing	30300030CH	2	Right Intercooler	32903720CH	1
Oil Seal	30300040CH	1	Crankcase	33104600CH	1
Bearing Carrier	30400830CH	1	Sight Gauge	36500140CH	1
Bearing Carrier	30400860CH	1	3/8" Breather/Oil Fill Plug	36507050CH	1
Gasket	30500050CH	1	Plug	36506800CH	1
Gasket	30500130CH	1	Connector	3690211ACH	1
Gasket	30500150CH	1	Bolt	37300250CH	4
O-Ring	30502400CH	2	Bolt	37301130CH	6
O-Ring	30502500CH	2	Bolt	37301140CH	14
Gasket	30504630CH	1	Bolt	37302480CH	6
Gasket	30504740CH	1	Bolt	37302530CH	4
Gasket	30504760CH	1	Nut	37400220CH	4
Gasket	30504770CH	1	Nut	37400720CH	1
O-Ring	30509290CH	1	Washer	37500310CH	4
Flywheel	31004620CH	1	Washer	37508130CH	14
Bearing Shell	31100210CH	2	Washer	37500400CH	6
Bushing*	31102250CH	2	Washer	37500730CH	1
Connecting Rod Assembly	31104840CH1	2	Snap Ring	37602260CH	4
Ring - LP	31203570CH	1	Filter Element	431	1
Ring - LP	31203580CH	1	Plug	BLSQPL0250	1
Ring - LP	31203590CH	1	Silencer/Filter Assembly	FS14050	1
Piston - LP	31203600CH	1	Ring Set	K24RINGS	1
Piston Pin - LP	31203610CH	1	Gasket Set	K24GASKETS	1
Piston Pin - HP	31204670CH	1	Valve Plate Assembly	2400VK24	1
Ring - HP	31204700CH	2	INTERCOOLER/AFTERCOOLER PARTS PRIOR TO		
Ring - HP	31204710CH	1	AUGUST 2002		
Ring - HP	31204720CH	1	Gasket	30501490CH	2
Piston - HP	31206180CH	1	Intercooler	32901460CH	2
Head	31304890CH	1	Connector	36904930CH	1
Cylinder	31604730CH	1	Bolt	37302530CH	4
Valve - HP	32700350CH	2	Nut	37404940CH	2
Valve - LP	32703560CH	2			
Valve Plate	3270475ACH	2			

*Bushing is not machined to fit piston pin if ordered separate from connecting rod.